

COAXIAL CABLES: RG-174/U  
RG-188/U  
RG-316/U

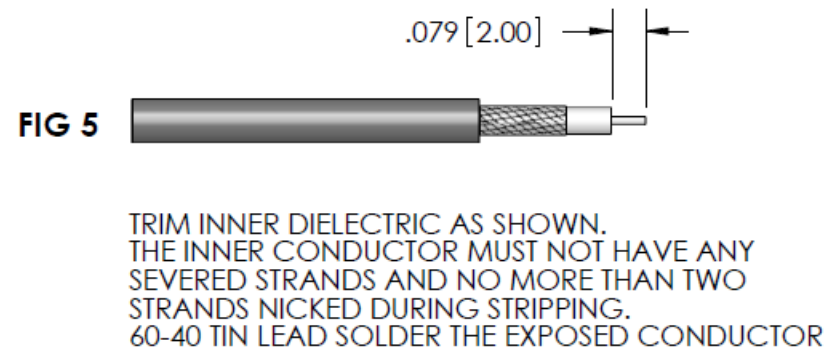
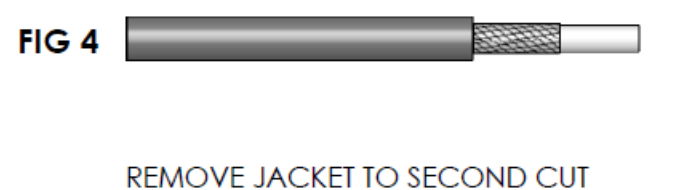
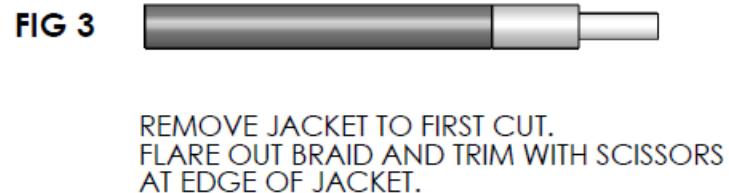
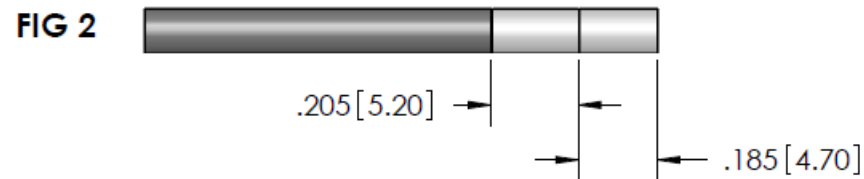
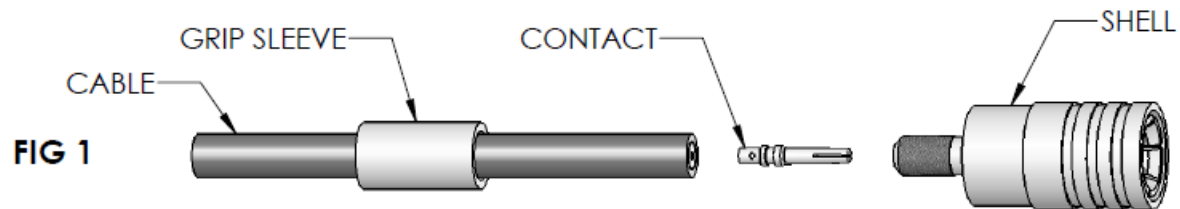
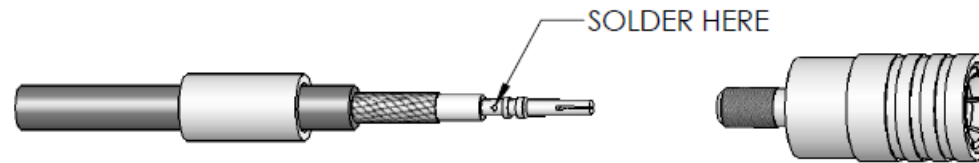
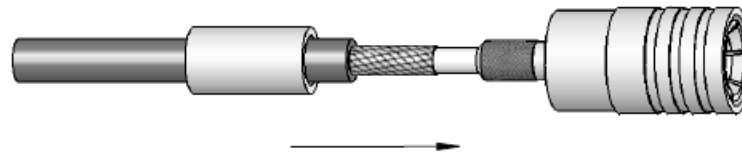
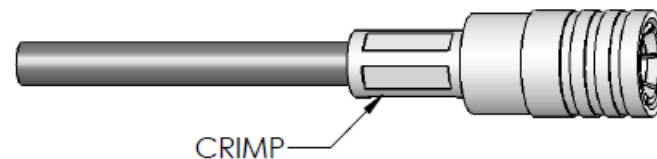

**FIG 6**

SLIDE CONTACT OVER CONDUCTOR AND SOLDER IN PLACE USING 60-40 TIN LEAD SOLDER. -DO NOT OVERHEAT- REMOVE EXCESS SOLDER FROM OUTSIDE OF CONTACT.

**FIG 7**

SLIDE CABLE ASSEMBLY INTO SHELL. GUIDE BRAID OVER KNURLED COLLAR ON SHELL UNTIL CONTACT SHOULDER BUTTS AGAINST SHELL INSULATOR.

**FIG 8**

SLIDE GRIP SLEEVE INTO POSITION AND CRIMP. USE AMPHENOL CRIMP TOOL 227-944 AND CRIMP DIE 227-1221-03 CAV. A ENSURE THAT BRAID DOES NOT EXTEND BEYOND GRIP SLEEVE.