

Sub-D vacuum side connector to wire assembly

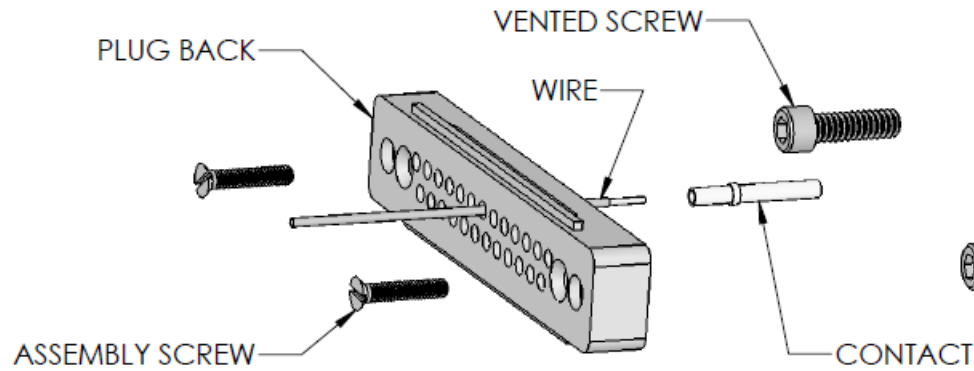
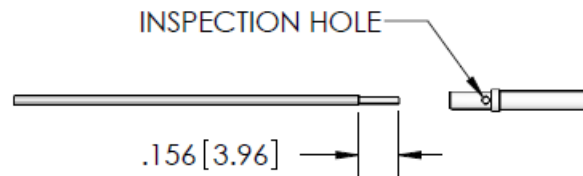

FIG 2



FEED WIRE THROUGH PLUG BACK AND STRIP END OF WIRE TO DIMENSION SHOWN. INSERT WIRE FULLY INTO CONTACT, WIRE SHOULD BE VISIBLE IN INSPECTION HOLE. CRIMP WIRE TO CONTACT CENTER CRIMP BETWEEN END OF CONTACT AND INSPECTION HOLE.

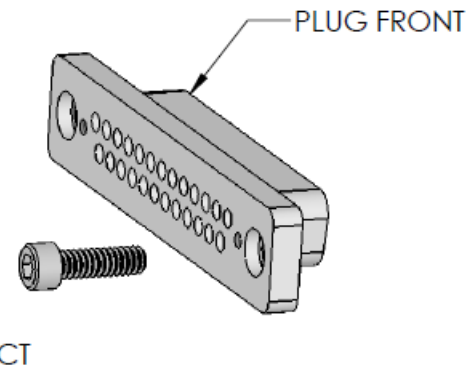
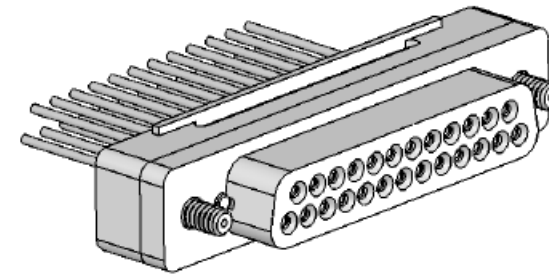

FIG 3



INSERT VENTED SCREWS INTO COUNTERBORES IN PLUG FRONT. THEN INSERT CONTACTS INTO PLUG FRONT HOLES. ALIGN PLUG BACK AND PLUG FRONT. INSERT ASSEMBLY SCREWS IN PLUG BACK AND TIGHTEN.